

NOTICE!!

These documents have been scanned!

Do not place un-scanned documents beneath this notice!

Do not remove this notice from this file!

GPO Jacket No. 560-102
Print Order 61540
Rise Business Services, LLC
Job=AZ15 4/30/2019



Box Number= AZ15011



Claim Begin-End: AMC441682-AMC441682

1 Initial Receipt



AZ15011-21

AMC450400-AMC453366

United States Department of the Interior
Bureau of Land Management
 DIV OF LANDS, MINRLS & ENERGY
 ONE N CENTRAL AVE
 PHOENIX, AZ 85004 -4427
 Phone: 602-417-9200

Receipt

No: 3762089

Transaction #: 3868073	
Date of Transaction: 02/13/2017	
CUSTOMER:	
STEPHEN STEEL 428 N MAIN ST GLADEWATER, TX 75647-2230 US	

LINE #	QTY	DESCRIPTION	REMARKS	UNIT PRICE	TOTAL
1	1.00	LOCATABLE MINERALS / MINING CLAIMS- NEW, UNADJUD, ONE OR MORE AUTH NOS / NEW MINING CLAIM PROCESSING FEE CASES: AMC441682/\$20.00		- n/a -	20.00
2	1.00	LOCATABLE MINERALS / MINING CLAIMS- NEW, UNADJUD, ONE OR MORE AUTH NOS / NEW MINING CLAIMS LOCATION FEE CASES: AMC441682/\$37.00		- n/a -	37.00
3	1.00	LOCATABLE MINERALS / MINING CLAIMS- NEW, UNADJUD, ONE OR MORE AUTH NOS / NEW MINING CLAIMS MAINTENANCE FEE CASES: AMC441682/\$155.00		- n/a -	155.00
4	1.00	IAC PRODUCTS / MAPS-BLM / SPECIAL ORDERS / MAPS MADE TO ORDER	CUSTOM MAP OF T6 R6 SEC33	10.00	10.00
TOTAL:					\$222.00

PAYMENT INFORMATION			
NOTE: Items will appear on credit card statement as "Bureau of Land Mgmt CO".			
1	AMOUNT:	222.00	POSTMARKED: N/A
	TYPE:	CREDIT CARD	RECEIVED: 02/13/2017
	NAME:	GREENWOOD, DON 428 N MAIN ST GLADEWATER TX 75647-2230 US	
	CARD NO:	XXXXXXXXXXXX0402	AUTH CODE: 01380P

NAME ON CARD:	DON GREENWOOD
EXPIRES:	12/2017
SIGNATURE:	

REMARKS

This receipt was generated by the automated BLM Collections and Billing System and is a paper representation of a portion of the official electronic record contained therein.

NOTICE!!

These documents have been scanned!

Do not place un-scanned documents beneath this notice!

Do not remove this notice from this file!

GPO Jacket No. 560-102
Print Order 61540
Rise Business Services, LLC
Job=AZ15 4/30/2019

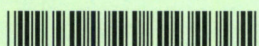

Box Number= AZ15011



Claim Begin-End: AMC441682-AMC441682

2 Correspondence



AZ15011-21

AMC450400-AMC453366



United States Department of the Interior



BUREAU OF LAND MANAGEMENT

Arizona State Office

One North Central Avenue, Suite 800

Phoenix, Arizona 85004-4427

www.blm.gov/az/

MAR 08 2018

In Reply Refer To:

3800 (9200) RM

AMC441682

CERTIFIED MAIL - RETURN RECEIPT REQUESTED No. 9214 8901 9403 8304 7881 49

NOTICE

CHARLES S SCHERMERHORN
11703 W 223RD ST
BUCYRUS, KS 66013-9275

:
:
:

This Notice Affects the Claims
Shown in the Block Below.

AMC441682

SCORPION REDEMPTION 1

Mining Claim Location Notice(s) – Amendment(s) Required

Pursuant to Title 43 Code of Federal Regulations (CFR) 3832.1, the Bureau of Land Management (BLM), Arizona State Office, received your notices of location for recording mining claims. In accordance with 43 CFR 3832.12, the claims listed above cannot be accepted as filed and must be amended as noted below.

- The claims are not described with a proper metes and bounds description. A proper metes and bounds description is required to accurately determine the location of the claims.
- The map you provided depicts the claim as being in the SE1/4 of section 33. The description you provided states the claim is in the SW 1/4.

In accordance with 43 CFR 3832.12 a lode claim must be described by metes and bounds and include a tie to a permanent monument such as a section quarter corner monument. All claim descriptions must include state, meridian, township, range, section and by aliquot part to the quarter section.

An amendment must be filed for each claim listed above to correct the defects identified. There is a \$10 BLM processing fee for each amendment. The amendments must be received by BLM within 30 days of your receipt of this notice. If the amendments are not received within the 30-day timeframe the mining claims will be declared null and void.

If additional information is required, please contact RéAnn Myers at 602-417-9413. Please include your AMC serial number(s) on all correspondence.



Lucas Lucero
Deputy State Director
Lands, Minerals and Energy Division

Enclosure



Date Produced: 03/19/2018

ConnectSuite Inc.:

The following is the delivery information for Certified Mail™/RRE item number 9214 8901 9403 8304 7881 49. Our records indicate that this item was delivered on 03/12/2018 at 09:48 a.m. in BUCYRUS, KS 66013. The scanned image of the recipient information is provided below.

Signature of Recipient :

A handwritten signature in black ink, appearing to be "D. J. [unclear]".

Address of Recipient :

A handwritten address in black ink, appearing to be "11707".

Thank you for selecting the Postal Service for your mailing needs. If you require additional assistance, please contact your local post office or Postal Service representative.

Sincerely,
United States Postal Service

The customer reference number shown below is not validated or endorsed by the United States Postal Service. It is solely for customer use.

Customer Reference Number: C724730.4378042

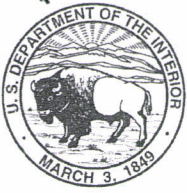

United States Department of the Interior



BUREAU OF LAND MANAGEMENT

Arizona State Office

One North Central Avenue, Suite 800

Phoenix, Arizona 85004-4427

www.blm.gov/az/

MAR 08 2018

In Reply Refer To:

3800 (9200) RM

AMC441682

CERTIFIED MAIL - RETURN RECEIPT REQUESTED No. 9214 8901 9403 8304 7881 56

NOTICE

STEPHEN STEELE

4075 PIGNUT RD

GILMER, TX 75644-8724

:
:
:

This Notice Affects the Claims

Shown in the Block Below.

AMC441682

SCORPION REDEMPTION 1

Mining Claim Location Notice(s) – Amendment(s) Required

Pursuant to Title 43 Code of Federal Regulations (CFR) 3832.1, the Bureau of Land Management (BLM), Arizona State Office, received your notices of location for recording mining claims. In accordance with 43 CFR 3832.12, the claims listed above cannot be accepted as filed and must be amended as noted below.

- The claims are not described with a proper metes and bounds description. A proper metes and bounds description is required to accurately determine the location of the claims.
- The map you provided depicts the claim as being in the SE1/4 of section 33. The description you provided states the claim is in the SW ¼.

In accordance with 43 CFR 3832.12 a lode claim must be described by metes and bounds and include a tie to a permanent monument such as a section quarter corner monument. All claim descriptions must include state, meridian, township, range, section and by aliquot part to the quarter section.

An amendment must be filed for each claim listed above to correct the defects identified. There is a \$10 BLM processing fee for each amendment. The amendments must be received by BLM within 30 days of your receipt of this notice. If the amendments are not received within the 30-day timeframe the mining claims will be declared null and void.

If additional information is required, please contact RéAnn Myers at 602-417-9413. Please include your AMC serial number(s) on all correspondence.

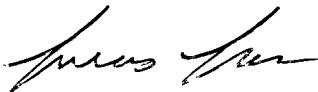

Lucas Lucero
Deputy State Director
Lands, Minerals and Energy Division

Enclosure

Date Produced: 03/19/2018

ConnectSuite Inc.:

The following is the delivery information for Certified Mail™/RRE item number 9214 8901 9403 8304 7881 56. Our records indicate that this item was delivered on 03/12/2018 at 02:45 p.m. in GILMER, TX 75644. The scanned image of the recipient information is provided below.

Signature of Recipient :



Address of Recipient :



Thank you for selecting the Postal Service for your mailing needs. If you require additional assistance, please contact your local post office or Postal Service representative.

Sincerely,
United States Postal Service

The customer reference number shown below is not validated or endorsed by the United States Postal Service. It is solely for customer use.

Customer Reference Number: C724730.4378043

NOTICE!!

These documents have been scanned!

Do not place un-scanned documents beneath this notice!

Do not remove this notice from this file!

GPO Jacket No. 560-102
Print Order 61540
Rise Business Services, LLC
Job=AZ15 4/30/2019



Box Number= AZ15011



Claim Begin-End: AMC441682-AMC441682

3 Transfers



AZ15011-21

AMC450400-AMC453366

**NO
DOCUMENTS
FOUND**

NO DOCUMENTS FOUND
NO DOCUMENTS FOUND

NOTICE!!

These documents have been scanned!

Do not place un-scanned documents beneath this notice!

Do not remove this notice from this file!

GPO Jacket No. 560-102
Print Order 61540
Rise Business Services, LLC
Job=AZ15 4/30/2019



Box Number= AZ15011



Claim Begin-End: AMC441682-AMC441682

4 Annual Filings



AZ15011-21

AMC450400-AMC453366

UNITED STATES
DEPARTMENT OF THE INTERIOR
BUREAU OF LAND MANAGEMENT
MAINTENANCE FEE WAIVER CERTIFICATION

98
JME

425516 441663
430214 441682
FORM APPROVED
OMB NO. 1004-0114
Expires: January 31, 2020
430219 425080

SEE INSTRUCTIONS ON PAGE 2

- This small miner waiver is filed for the assessment year beginning on September 1, 2018 and ending on September 1, 2019.
- The undersigned and all related parties owned ten or fewer mining claims, mill, or tunnel sites located and maintained on Federal lands in the United States of America on September 1, 2018.
- The undersigned have performed the assessment work required by law for each mining claim listed prior to filing this waiver and understand that by filing this form, the undersigned must file an affidavit of assessment work with the Bureau of Land Management (BLM) by the December 30th following the filing of this waiver.
- The undersigned understand that if the assessment work obligation has not yet come due under 30 U.S.C. 28 (for those claims in their first assessment year only), a notice of intent to hold reciting this condition must be recorded by the December 30th following the filing of this waiver.
- The undersigned understand that mill and tunnel sites may also be listed on this waiver and be waived from payment of the maintenance fee, and that a notice of intent to hold for these sites is required to be filed with the BLM by the December 30th following the filing of this waiver.
- The undersigned understand and acknowledge that pursuant to 43 U.S.C. 1212 and 18 U.S.C. 1001, the filing or recording of a false, fictitious, or fraudulent document with the BLM may result in a fine of up to \$250,000, a prison term not to exceed five years, or both.
- The mining claims, mill or tunnel sites for which this waiver from payment of the maintenance fees is requested are: 425558

CLAIM OR SITE NAME	BLM RECORDATION SERIAL NUMBER
1. D+S Mine GN 6W Sec 25 ✓	441663
2. Scorpion Redemption 1 GN 6W Sec 33	441682
3. Great Gold #1 7N 3W Sec 23	425080
4. HP4 GN 6W Sec 25	425516
5. Vulture Cloud #2 GN 6W Sec 24	430216
6. Carol's Gold Nugget #4 GN 6W Sec 24	425561
7. Vulture Cloud #4 GN 6W Sec 23	430222
8.	
9.	
10.	

RECEIVED
 BLM AZ STATE OFFICE
 2018 JUL 16 P 3:08
 PHOENIX, ARIZONA

The owner(s) (claimants) of the above mining claims and sites are:

Don Greenwood
(Owner's Name - Please Print)
428 North Main
(Owner's Mailing Address)

[Signature]
(Owner's Signature)
Gladewater TX 75847
(City) (State) (Zip Code)

JAN Greenwood
(Owner's Name - Please Print)
428 North main
(Owner's Mailing Address)

[Signature]
(Owner's Signature)
Gladewater TX 75847
(City) (State) (Zip Code)

Stephen Steele
(Owner's Name - Please Print)
4075 Pigout Rd
(Owner's Mailing Address)

[Signature]
(Owner's Signature)
Gilmer TX 75844
(City) (State) (Zip Code)

Charles Schermerhorn
(Owner's Name - Please Print)
11703 N. 223rd
(Owner's Mailing Address)

[Signature]
(Owner's Signature)
BUCKYRUS KS 66013
(City) (State) (Zip Code)

(Continued on page 2)

ENTERED
SEP 05 2018
BY: [Signature]

[Signature]



United States Department of the Interior



BUREAU OF LAND MANAGEMENT

Arizona State Office

One North Central Avenue, Suite 800

Phoenix, Arizona 85004-4427

www.blm.gov/az/

MAR 08 2018

In Reply Refer To:
3800 (9200) RM
AMC441682

CERTIFIED MAIL - RETURN RECEIPT REQUESTED No. 9214 8901 9403 8304 7881 32

NOTICE

DONALD GREENWOOD	:	This Notice Affects the Claims
428 N MAIN ST	:	Shown in the Block Below.
GLADEWATER, TX 75647-2230	:	

AMC441682
SCORPION REDEMPTION 1

Mining Claim Location Notice(s) – Amendment(s) Required

Pursuant to Title 43 Code of Federal Regulations (CFR) 3832.1, the Bureau of Land Management (BLM), Arizona State Office, received your notices of location for recording mining claims. In accordance with 43 CFR 3832.12, the claims listed above cannot be accepted as filed and must be amended as noted below.

- The claims are not described with a proper metes and bounds description. A proper metes and bounds description is required to accurately determine the location of the claims.
- The map you provided depicts the claim as being in the SE1/4 of section 33. The description you provided states the claim is in the SW ¼.

In accordance with 43 CFR 3832.12 a lode claim must be described by metes and bounds and include a tie to a permanent monument such as a section quarter corner monument. All claim descriptions must include state, meridian, township, range, section and by aliquot part to the quarter section.

An amendment must be filed for each claim listed above to correct the defects identified. There is a \$10 BLM processing fee for each amendment. The amendments must be received by BLM within 30 days of your receipt of this notice. If the amendments are not received within the 30-day timeframe the mining claims will be declared null and void.

If additional information is required, please contact RéAnn Myers at 602-417-9413. Please include your AMC serial number(s) on all correspondence.



Lucas Lucero
Deputy State Director
Lands, Minerals and Energy Division

Enclosure



Date Produced: 04/09/2018

ConnectSuite Inc.:

The following is the delivery information for Certified Mail™/RRE item number 9214 8901 9403 8304 7881 32. Our records indicate that this item was delivered on 04/04/2018 at 08:50 a.m. in GLADEWATER, TX 75647. The scanned image of the recipient information is provided below.

Signature of Recipient :

A handwritten signature in black ink that reads "Jim Irwin" with a stylized flourish at the end.

Address of Recipient :

A handwritten address in black ink that reads "428 N MAIN" with a checkmark at the end.

Thank you for selecting the Postal Service for your mailing needs. If you require additional assistance, please contact your local post office or Postal Service representative.

Sincerely,
United States Postal Service

The customer reference number shown below is not validated or endorsed by the United States Postal Service. It is solely for customer use.

Customer Reference Number: C724730.4378041

When Recorded Return Docur. to:
Don Greenwood
428 N. MAIN
Gladewater, TX. 75647

441663
 441682
 425080
 425558
 425516
 430214
 430219

Check here is this is a change of address.

Telephone: 903-235-0494

E-mail address: Mary R 41 AOL.com

AFFIDAVIT OF PERFORMANCE OF ANNUAL WORK

1. State of Arizona, County of MARICOPA ss:

2. I (Name) Don Greenwood

3. Reside at (Address) 428 N. main

City Gladewater County Gress

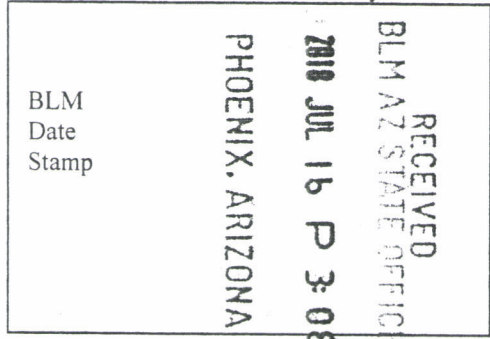

State TX Zip 75647 being duly sworn, depose and say that I am a citizen of the United States, more than eighteen years of age, and that all of the facts set forth in this affidavit, subject to the provisions and penalties of 18 U.S.C. 1001 pertaining to the filing of false, fictitious, or fraudulent statements with the United States, are true and correct according to the best of my knowledge, information and belief.

4. Owner's name and address (If not shown in Items 1-3 above). _____

5. That I am personally acquainted with the mining claim(s). The work and improvements were made by and at the expense of the owner(s) of said claim(s). Said contiguous group of claims, listed on this document, are situated in the

_____ (optional) Mining District; _____ County, Arizona.

Line No.	AMC NUMBER	CLAIM/SITE NAME	COUNTY RECORDER DATA (If available)	TWP	RNG	SEC
1	441663	D+S mine	0118718-2-1-1 Haro's	6N	6W	25
2	441682	Scorpion Redemption 1	0126731-2-1-1 RAMIREZ J	6N	6W	33
3	425080	Great Gold #1	1057538-2-3-2 GARCIA C	7N	3W	23
4	425516	HP 4		6N	6W	25
5	430216	Vulture Cloud 2		6N	6W	24
6	425561	Carol's Gold Nugget 4		6N	6W	24

Form: MCF108
 Revised July 2014
 Page 1 of 2

4213129

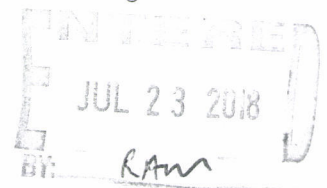

RECEIVED
BLM AZ STATE OFFICE
PHOENIX, ARIZONA
2018 JUL 16 P 3:08

BLM
Date
Stamp

7	430222	Vulture Cloud #4		GN	GW	23
8						
9						
10						

6. That between the dates starting at 12 o'clock noon on September 1, 20 17 and ending at 12 o'clock noon on September 1, 20 18 at least \$ 1,000 dollars worth of work and improvements were done and performed upon said claim(s) or upon one or more of a contiguous group of claims for the benefit of all, wholly or partly outside of a contiguous group of claims for the benefit of all, not including the location work.

7. That the following persons were employed to perform the work and improvements described herein: _____

Dan Greenwood, Stephen Stute, Charles Schermerhorn, Mike Seward

8. That the work and improvements performed were: Assaying and Testing of Vein Material
Maintenance of Road and ditches with hand tools, Restaking of 2 claim
were ~~see~~ Posts & Signs was destroyed.

9. Dated: _____ Signature: [Signature]

SUBSCRIBED AND SWORN TO before me, a Notary Public, this 15th day of JUNE 20 18

By: Tamara M. Alex

Notary Public Tamara M. Alex

My Commission Expires 8/22/2019

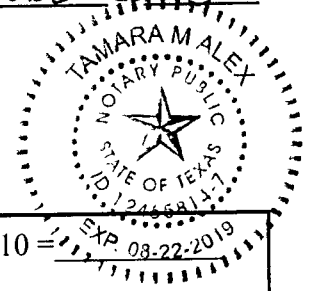

Bureau of Land Management
Arizona State Office
www.blm.gov/az

No. of Claims: _____ x \$10 = _____
 Check No.: _____ Init. _____
 Receipt No.: _____
 For BLM Use Only

Don Greenwood
428 N. main
Gladewater, TX 75647

RECEIVED
BLM AZ STATE OFFICE

2018 JUL 16 P 3:08

PHOENIX, ARIZONA

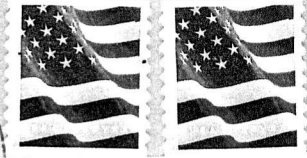
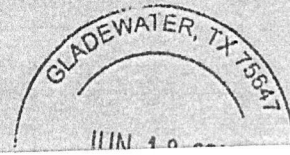

1000



85041

U.S. POSTAGE
PAID
GLADEWATER, TX
75647
JUN 18, 18
AMOUNT

\$0.21

R2305E124510-17

Bureau of Land Management
One N Central Ave
Suite 800
Phoenix, AZ
85041-4427

NIXIE 850415095-1N 07/04/18

RETURN TO SENDER
UNABLE TO FORWARD
UNABLE TO FORWARD
RETURN TO SENDER

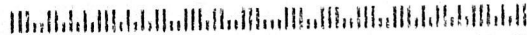

Dow Greenwood
428 N. main
Gladewater, TX 75847

JUL 20 18

12 JUL 2018
SHREVEPORT LA. 711
FRI 13 JUL 2018 AM



Bureau of Land Management
1 North Central Ave
Suite 800
Phoenix, AZ. 85004

RECEIVED
BLM AZ STATE OFFICE
2018 JUL 16 P 3:08
PHOENIX, ARIZONA

United States Department of the Interior
Bureau of Land Management
 DIV OF LANDS, MINRLS & ENERGY
 ONE N CENTRAL AVE
 PHOENIX, AZ 85004 -4427
 Phone: 602-417-9200

Receipt

No: 4213929

Transaction #: 4329027	
Date of Transaction: 07/17/2018	
CUSTOMER:	
DONALD GREENWOOD 428 N MAIN ST GLADEWATER, TX 75647-2230 US	

LINE #	QTY	DESCRIPTION	REMARKS	UNIT PRICE	TOTAL
1	1.00	LOCATABLE MINERALS / MINING CLAIMS- NOT NEW-UNADJUD, ONE AUTH NO. ONLY / MINING CLAIM MONEY RECEIVED CASES: AMC441663/\$70.00	POL 2018/7 WAV	- n/a -	70.00
TOTAL:					\$70.00

PAYMENT INFORMATION					
1	AMOUNT:	70.00	POSTMARKED:	N/A	
	TYPE:	CHECK	RECEIVED:	07/16/2018	
	CHECK NO:	2942			
	NAME:	GREENWOOD, DONALD 428 N MAIN ST GLADEWATER TX 75647-2230 US			

REMARKS

This receipt was generated by the automated BLM Collections and Billing System and is a paper representation of a portion of the official electronic record contained therein.

UNITED STATES
DEPARTMENT OF THE INTERIOR
BUREAU OF LAND MANAGEMENT

41

441663
441682

MAINTENANCE FEE WAIVER CERTIFICATION

FORM APPROVED
OMB NO. 1004-0114
Expires: October 31, 2016

425080

SEE INSTRUCTIONS ON PAGE 2

- This small miner waiver is filed for the assessment year beginning on September 1, 2019 and ending on September 1, 2018.
- The undersigned and all related parties owned ten or fewer mining claims, mill, or tunnel sites located and maintained on Federal lands in the United States of America on September 1,
- The undersigned have performed the assessment work required by law for each mining claim listed prior to filing this waiver and understand that by filing this form, the undersigned must file an affidavit of assessment work with the Bureau of Land Management (BLM) by the December 30th following the filing of this waiver.
- The undersigned understand that if the assessment work obligation has not yet come due under 30 U.S.C. 28 (for those claims in their first assessment year only), a notice of intent to hold reciting this condition must be recorded by the December 30th following the filing of this waiver.
- The undersigned understand that mill and tunnel sites may also be listed on this waiver and be waived from payment of the maintenance fee, and that a notice of intent to hold for these sites is required to be filed with the BLM by the December 30th following the filing of this waiver.
- The undersigned understand and acknowledge that pursuant to 43 U.S.C. 1212 and 18 U.S.C. 1001, the filing or recording of a false, fictitious, or fraudulent document with the BLM may result in a fine of up to \$250,000, a prison term not to exceed five years, or both.
- The mining claims, mill or tunnel sites for which this waiver from payment of the maintenance fees is requested are:

CLAIM OR SITE NAME	BLM RECORDATION SERIAL NUMBER
1. <u>D+S mine 6N 6W Sec 25</u>	<u>441663</u>
2. <u>Scorpion Redemption 1 6N6W Sec 33</u>	<u>441682</u>
3. <u>Great Gold #1 7N 3W Sec 23</u>	<u>425080</u>
4.	
5.	
6.	
7.	
8.	
9.	
10.	

AC 483
PB
ENTERED SEP 01 2017

The owner(s) (claimants) of the above mining claims and sites are:

NW CHECK

3ct Don Greenwood ✓
(Owner's Name - Please Print)

428 North main
(Owner's Mailing Address)

(Owner's Signature)

Gladewater TX 75647
(City) (State) (Zip Code)

1ct Jan Greenwood ✓
(Owner's Name - Please Print)

428 North main
(Owner's Mailing Address)

(Owner's Signature)

Gladewater TX 75647
(City) (State) (Zip Code)

2ct Stephen Steele ✓ AC 170 Entered
(Owner's Name - Please Print)

4075 Pigout Road Address update 2/9/17
(Owner's Mailing Address)

Stephen Steele

(Owner's Signature)

Gilmer, TX 75844
(City) (State) (Zip Code)

3ct Charles Schermerhorn ✓
(Owner's Name - Please Print)

11703 N. 223rd
(Owner's Mailing Address)

(Owner's Signature)

Bucyrus KS 66013
(City) (State) (Zip Code)

2017 MAY 30 P 3:53

(Owner's Name - Please Print)

(Owner's Signature)

(Owner's Mailing Address)

(City)

(State)

(Zip Code)

(Owner's Name - Please Print)

(Owner's Signature)

(Owner's Mailing Address)

(City)

(State)

(Zip Code)

(Owner's Name - Please Print)

(Owner's Signature)

(Owner's Mailing Address)

(City)

(State)

(Zip Code)

(Owner's Name - Please Print)

(Owner's Signature)

(Owner's Mailing Address)

(City)

(State)

(Zip Code)

8 U.S.C. 1001 and 43 U.S.C. 1212 make it a crime for any person knowingly and willfully to make to any department or agency of the United States any false, fictitious or fraudulent statements or representations as to any matter within its jurisdiction.

INSTRUCTIONS

This certification is made under the provisions of 43 U.S.C. § 1744 and 30 U.S.C. §28-28k and the regulations thereunder (43 CFR Part 3830).
 The claimant(s) must fill in the dates in paragraph 1 for the beginning and ending of the assessment year for which this waiver is sought.
 The claimant(s) must fill in the date in paragraph 2 for the beginning of the assessment year for which this waiver is sought.
 All claim and site names and BLM serial numbers must be listed for the mining claims, mill sites, and tunnel sites for which the waiver is sought.
 All owners of the mining claims, mill sites, and tunnel sites and their addresses must be given.
 This waiver form must be signed by all the claimants or their designated agent, in original form. If an agent is designated, a notarized designation of agent, signed by all of the claimants with proper address given, must be submitted with this waiver.
 This form must be filed no later than September 1st for the upcoming assessment year in the BLM State Office where the mining claims or sites are recorded, or the waiver cannot be granted by the BLM. (Example: To obtain a waiver for the assessment year 2012, which begins on September 1, 2011, you must qualify for and file for a waiver no later than September 1, 2011, in the proper BLM State Office.)
 For all mining claims which require assessment work, you must record an affidavit of labor on or before the December 30th immediately following the filing of this waiver. For all other mining claims or sites waived, you must record a notice of intent to hold on or before the December 30th immediately following the filing of this waiver.
 Mill and tunnel sites may also be listed on this waiver and be waived from payment of the maintenance fee. A notice of intent to hold for these sites is required to be filed by the December 30th following the filing of this waiver.

FOR OFFICIAL USE ONLY

2011 MAY 11 10:53 AM
 PHOENIX, ARIZONA
 P 3-53

Customer Name Update Screen

System ID:MC

Name: STEELE STEPHEN

Lookup

Proprietor #: 2409549

Renumber To:

Category: P - PRIVATE

Address: 4075 PIGNUT RD

City: GILMER

State: TX

Lookup

Zip: 756448724

UNDELIVERABLE

No Annual Reminders

Email:

Phone:

*Per 2018 WVR
AC 170
ENTERED SEP 05 2017
PB*

Save

Save/Override DataFlux

Delete

Renumber

Customer details successfully saved for Customer Id 2409549

List of Proprietors

STEELE STEPHEN[2409549], 428 N MAIN ST, , GLADEWATER, TX, 756472230, P, MATCHED

↑
PREVIOUS ADDRESS

Select

Cancel

UNITED STATES DEPARTMENT OF THE INTERIOR
BUREAU OF LAND MANAGEMENT

MC NATIONWIDE CLAIMANT LISTING
September 05, 2017

Cust	AZ CLAIMANT	National Total
GREENWOOD DONALD 428 N MAIN ST GLADEWATER, TX 75647-2230	3	3
GREENWOOD JANET 428 N MAIN ST GLADEWATER, TX 75647-2230	1	1
SCHERMERHORN CHARLES S 11703 W 223RD ST BUCYRUS, KS 66013-9275	3	3
STEELE STEPHEN 428 N MAIN ST GLADEWATER, TX 75647-2230	2	2

When Recorded Return Document to:

Don Greenwood
428 N. Main
Gladewater, TX 75647

441663
441682
425080

Check here is this is a change of address.

Telephone: 903-235-0494

E-mail address: MARYR 41 @ AOL.COM

AFFIDAVIT OF PERFORMANCE OF ANNUAL WORK

1. State of Arizona, County of MARICOPA ss:

2. I (Name) Don Greenwood

3. Reside at (Address) 428 N. Main

City Gladewater County Gregg

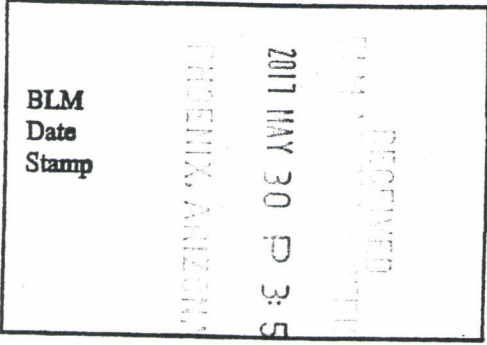

State TX Zip 75647 being duly sworn, depose and say that I am a citizen of the United States, more than eighteen years of age, and that all of the facts set forth in this affidavit, subject to the provisions and penalties of 18 U.S.C. 1001 pertaining to the filing of false, fictitious, or fraudulent statements with the United States, are true and correct according to the best of my knowledge, information and belief.

4. Owner's name and address (if not shown in items 1-3 above) _____

5. That I am personally acquainted with the mining claim(s). The work and improvements were made by and at the expense of the owner(s) of said claim(s). Said contiguous group of claims, listed on this document, are situated in the

(optional) Mining District; Maricopa County, Arizona.

Line No.	AMC NUMBER	CLAIM/SITE NAME	COUNTY RECORDER DATA (If available)	TWP	RNG	SEC
1	441663	D+S mine	0118718-2-1-1 HAROJ	6N	6W	25
2	441682	Scorpio Redemption 1	0126731-2-1-1 RAMIREZJ	6N	6W	33
3	425080	Great Gold #1	1057538-2-3-2 GARCIA C	7N	3W	23
4						
5						
6						

Form: MCF108
Revised July 2014
Page 1 of 2

ENTERED
JUN 05 2017
BY: R Am

BLM
Date
Stamp

2017 MAY 30 PM 3:53

7					
8					
9					
10					

6. That between the dates starting at 12 o'clock noon on September 1, 20 16 and ending at 12 o'clock noon on September 1, 20 17 at least \$ 600 dollars worth of work and improvements were done and performed upon said claim(s) or upon one or more of a contiguous group of claims for the benefit of all, wholly or partly outside of a contiguous group of claims for the benefit of all, not including the location work.

7. That the following persons were employed to perform the work and improvements described herein: _____
Don Greenwood, Stephen Steele, Charles Schermerhorn

8. That the work and improvements performed were: Assaying and Testing of Vein material, maintenance of Road and ditches with hand Tools

9. Dated: 5-23-17 Signature: [Signature]

SUBSCRIBED AND SWORN TO before me, a Notary Public, this 23 day of May 20 17

By: Donna Greenwood
 Notary Public Judy Kathleen Van Houten
 My Commission Expires 2-13-2021

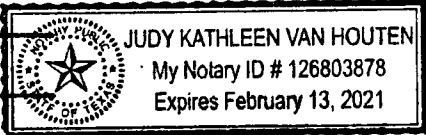

Bureau of Land Management
 Arizona State Office
www.blm.gov/az

No. of Claims: 4 x \$10 = 40.00
 Check No.: 2840 Init. JK
 Receipt No.: 3849712
 For BLM Use Only

UNITED STATES
DEPARTMENT OF THE INTERIOR
Bureau of Land Management
Arizona State Office
1 North Central Avenue, Suite 800

Phoenix, Arizona 85004

OFFICIAL BUSINESS
PENALTY FOR PRIVATE USE \$300

AN EQUAL OPPORTUNITY EMPLOYER SHREVEPORT LA 710

24 MAY 2017 PM 1 L

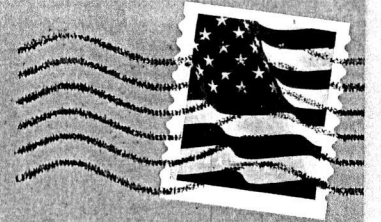

RECEIVED
BLM ARIZONA STATE OFFICE
2017 MAY 30 P 3:49
PHOENIX, ARIZONA

Bureau of Land Management
One North Central Avenue
Suite 800
Phoenix, AZ 85004-4427

RECEIVED
BLM ARIZONA STATE OFFICE
2017 MAY 30 P 3:53
PHOENIX, ARIZONA

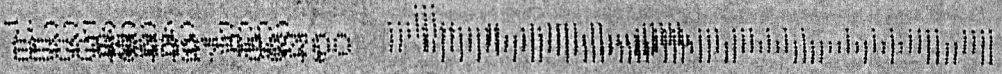

**United States Department of the Interior
Bureau of Land Management
DIV OF LANDS, MINRLS & ENERGY
ONE N CENTRAL AVE
PHOENIX, AZ 85004 -4427
Phone: 602-417-9200**

Receipt

No: 3849712

Transaction #: 3958315	
Date of Transaction: 05/31/2017	
CUSTOMER:	
	DONALD GREENWOOD 428 N MAIN ST GLADEWATER, TX 75647-2230 US

LINE #	QTY	DESCRIPTION	REMARKS	UNIT PRICE	TOTAL
1	1.00	LOCATABLE MINERALS / MINING CLAIMS- NOT NEW-UNADJUD, ONE AUTH NO. ONLY / MINING CLAIM MONEY RECEIVED CASES: AMC441663/\$30.00	POL 2017/3 WAV	- n/a -	30.00
2	1.00	OVERPAYMENT / OVERPAYMENT OF FEES / OVERPAYMENT OF \$1.00 OR MORE		10.00	10.00
TOTAL:					\$40.00

PAYMENT INFORMATION			
1	AMOUNT:	40.00	POSTMARKED: 05/24/2017
	TYPE:	CHECK	RECEIVED: 05/30/2017
	CHECK NO:	2840	
	NAME:	GREENWOOD, DON 428 N MAIN ST GLADEWATER TX 75647-2230 US	

REMARKS
3 AMC NOS. WERE PROVIDED ON FORM / \$40 WAS REMITTED IN CHECK FORM #2840

This receipt was generated by the automated BLM Collections and Billing System and is a paper representation of a portion of the official electronic record contained therein.

NOTICE!!

These documents have been scanned!

Do not place un-scanned documents beneath this notice!

Do not remove this notice from this file!

GPO Jacket No. 560-102
Print Order 61540
Rise Business Services, LLC
Job=AZ15 4/30/2019



Box Number= AZ15011



Claim Begin-End: AMC441682-AMC441682

5 Miscellaneous



AZ15011-21

AMC450400-AMC453366

United States Department of the Interior
Bureau of Land Management
 DIV OF LANDS, MINRLS & ENERGY
 ONE N CENTRAL AVE
 PHOENIX, AZ 85004 -4427
 Phone: 602-417-9200

Receipt

No: 4116405

Transaction #: 4229798	
Date of Transaction: 03/20/2018	
CUSTOMER:	
DONALD GREENWOOD 428 N MAIN ST GLADEWATER, TX 75647-2230 US	

LINE #	QTY	DESCRIPTION	REMARKS	UNIT PRICE	TOTAL
1	1.00	LOCATABLE MINERALS / MINING CLAIMS- NOT NEW-UNADJUD, ONE AUTH NO. ONLY / MINING CLAIM MONEY RECEIVED CASES: AMC441682/\$10.00	AMEND/1	- n/a -	10.00
TOTAL:					\$10.00

PAYMENT INFORMATION			
1	AMOUNT:	10.00	POSTMARKED: N/A
	TYPE:	CHECK	RECEIVED: 03/19/2018
	CHECK NO:	8361	
	NAME:	GREENWOOD, DONALD 428 N MAIN ST GLADEWATER TX 75647-2230 US	

REMARKS

This receipt was generated by the automated BLM Collections and Billing System and is a paper representation of a portion of the official electronic record contained therein.

*PRT LTR DTD 3/8/2018.
 CORRECTIVE LID & MAP.
 635 ENTERED 3/27/2018. RU*

LOCATION NOTICE FOR LODE MINING CLAIM

Amendment BLM Serial # AMC 44168-2

NOTICE IS HEREBY GIVEN that the Scorpion
Redemption 1 lode mining claim has been located
by Stephen Steele, Charles Schermerhorn, Don Greenwood
whose current mailing
address is 428 N. Main St
Gladewater, TX 75647

BLM
Date
Stamp
PHOENIX, ARIZONA
2016 MAR 19 P 2:25

The general course of this claim is _____ and it is situated in Maricopa
County, Arizona. This claim is 1500 feet in length and 600 feet in width.

20 Total Claim Acreage. This claim runs from the location monument on which this location notice
is posted on the centerline of the claim approximately 1500 feet in a S direction to the S
end line and 600 feet in a SE direction to the E end line. This claim is marked by six
monuments, one at each corner and one at the center of each end line of the claim.

The location monument on which this notice is posted is situated within Section 33, Township 6N
_____, Range 6 W, Gila Salt River Base and Meridian, Arizona and this claim encompasses portions
of the following quarter section(s), section(s), Township(s) and Range(s) NW corner of the
SE quarter of section 33

Gila Salt River Base and Meridian, Arizona.

The locality of this claim with reference to some natural object or permanent monument and additional information
(if any) concerning its locality are as follows: _____

_____ The above information is shown on the attached map.

DATED AND POSTED on the ground this 11 day of Feb, 2017.

LOCATOR(s) AGENT

Print Name(s) Stephen Steele Don Greenwood Charles Schermerhorn

Signature(s) Sty Steele Don Greenwood Charles Schermerhorn

Form MCF100
Revised July 2014

This form is available from the Arizona Geological Survey and may be reproduced.

CLAIMANT CALLED
IMMEDIATELY AFTER
MAILING, SAYING
IT WAS WRONG. CORRECT
ONE MAILED SAME DAY. PH
4116405

MINING CLAIM MAP

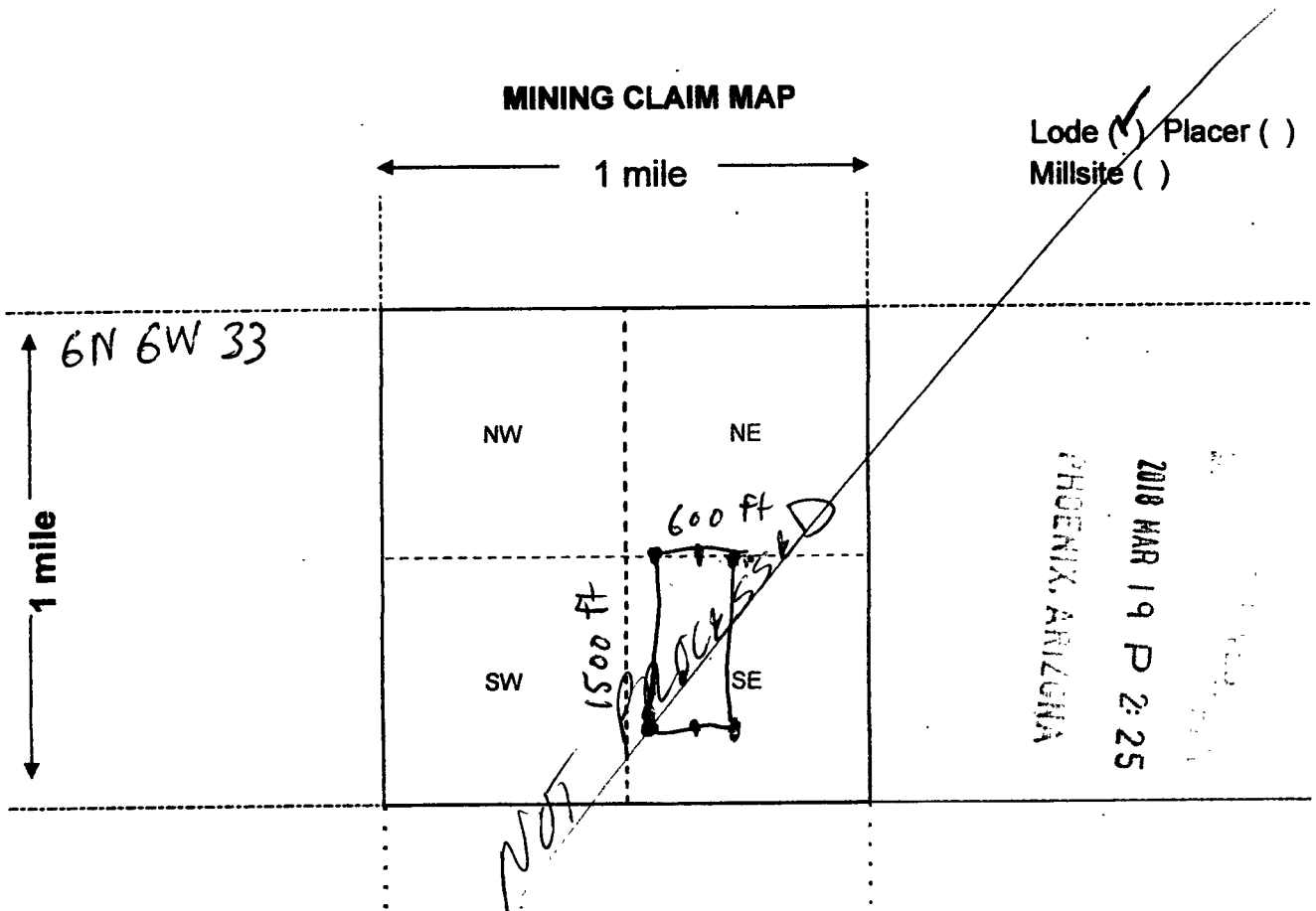

Lode (✓) Placer ()
Millsite ()

Scale: 1" = 2000 feet



1. The above map depicts the Scorpion Redemption 1 mining claim, which is located in Section (s) 33, Township 6 N, Range 6 W, Gila and Salt River Base and Meridian, Maricopa County, Arizona. Total claim acreage is 20

2. The type of corner and location monuments used are as follows: 2" PVC pipe with caps in rock base 5 ft above ground

3. The bearings and distances in degrees and feet between claim corners and to a public land survey monument are as depicted on the map.

4. If the claim is a placer or millsite claim with exterior limits conforming to legal subdivisions of the public survey, provide a legal description of the claim NW corner of the SE quarter of map section 33

Form MCF100a
Revised July 2014

LOCATION NOTICE FOR LODE MINING CLAIM

Amendment BLM Serial # _____

NOTICE IS HEREBY GIVEN that the Scorpion Redemption 1
_____ lode mining claim has been located
by Stephen Skel, Charles Schermerhorn, Don Greenwood whose current mailing
address is 428 North Main
Gladewater, TX 75647

RECEIVED
BLM AZ STATE OFFICE
2017 FEB 13 A 11:02
PHOENIX, ARIZONA
BLM
Date
Stamp

The general course of this claim is North/South and it is situated in Maricopa
County, Arizona. This claim is 1500 feet in length and 600 feet in width.

20 Total Claim Acreage. This claim runs from the location monument on which this location notice
is posted on the centerline of the claim approximately 1500 feet in a South direction to the South
end line and 300 feet in a SW direction to the W end line. This claim is marked by six
monuments, one at each corner and one at the center of each end line of the claim.

The location monument on which this notice is posted is situated within Section 33, Township 6N
Range 6 W, Gila Salt River Base and Meridian, Arizona and this claim encompasses portions
of the following quarter section(s), section(s), Township(s) and Range(s) NW corner of the
SW quarter of section 33

Gila Salt River Base and Meridian, Arizona.

The locality of this claim with reference to some natural object or permanent monument and additional information
(if any) concerning its locality are as follows: _____

_____ The above information is shown on the attached map.

DATED AND POSTED on the ground this 11 day of Feb, 20 17.

LOCATOR(s) AGENT

Print Name(s) Stephen Skel Don Greenwood Charles Schermerhorn
Signature(s) Stephen Skel Don Greenwood Charles Schermerhorn

Form MCF100
Revised July 2014

AMC441682

2018 MAR 19 P 2 25
PHOENIX, ARIZONA

MINING CLAIM MAP

Lode () Placer ()
Millsite ()

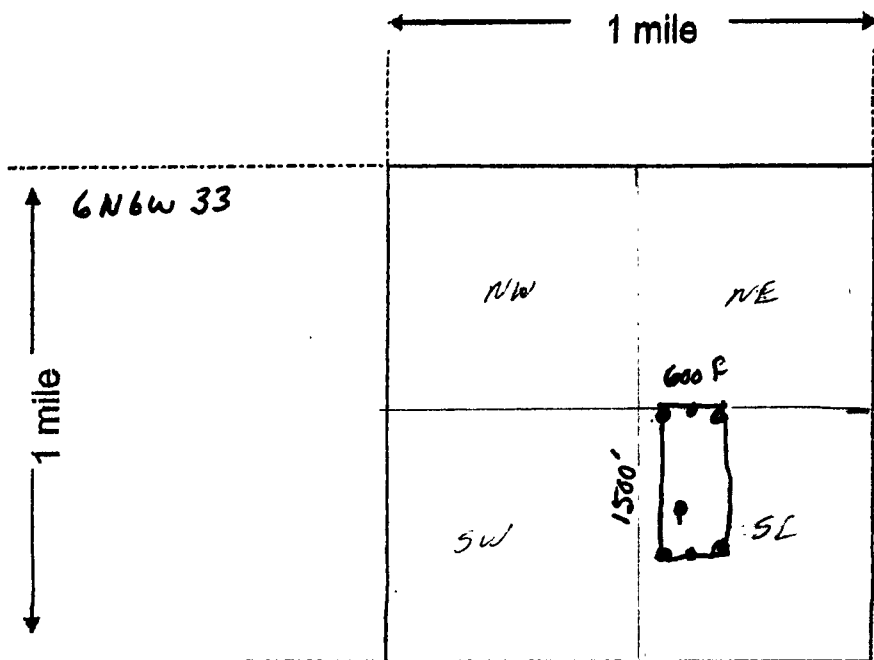

RECEIVED
 BLM AZ STATE OFFICE
 PHOENIX, ARIZONA
 2017 FEB 13 A 11:02

PHOENIX, ARIZONA
 2018 MAR 19 P 2:00

AMC 441682

Scale: 1" = 2000 feet



- The above map depicts the Scorpion Redemption 1 mining claim, which is located in Section (s) 33, Township 6 N, Range 6 W, Gila and Salt River Base and Meridian, Maricopa County, Arizona. Total claim acreage is 20
- The type of corner and location monuments used are as follows: 2" PVC Pine W caps in Rock Cairns 5 ft Above ground
- The bearings and distances in degrees and feet between claim corners and to a public land survey monument are as depicted on the map.
- If the claim is a placer or millsite claim with exterior limits conforming to legal subdivisions of the public survey, provide a legal description of the claim NW corner of the SW quarter of map sec 33

Form MCF100a
Revised July 2014

US Department of the Interior
Bureau of Land Management
1 N Central Ave Ste 800
Phoenix, AZ 85004

USPS CERTIFIED MAIL

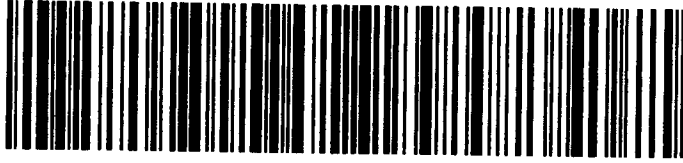

9214 8901 9403 8304 7881 56

PHOENIX, ARIZONA

2018 MAR 19 P 2:25

STEPHEN STEELE
4075 PIGNUT RD
GILMER TX 75644-8724

12 Mar 2018

To: Ms Myers,

if anything else is needed please let us know,
I hope this amendment where I corrected the
highlighted mistake is what you requested,

Thank you,

Stephen Steele

(903) 841-1063

Don Greenwood

(903) 235-0494

Stephen Steele
4075 Pignat Rd
Gilmer Tx 75844

SHREVEPORT LA 710

19 MAR 2018 PH2 L



RECEIVED
BLM AUSTIN OFFICE

2018 MAR 19 P 2:25

PHOENIX, ARIZONA

Bureau of Land Management
Arizona State office Attn: ReAnn Myers
One North Central Ave Suite 800
Phoenix AZ 85004-4427

85004-442700





Mary R Greenwood
428 N Main St
Gladewater TX 75647-2230

SHREVEPORT LA 710

14 MAR 2018 PM 3:1

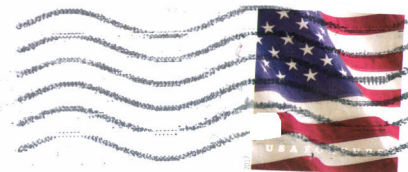

Bureau of Land Management
One N. Central Ave
Phoenix, AZ 85004-4427

PHOENIX, ARIZONA

2018 MAR 19 P 2:19

RECEIVED
BLM SHREVEPORT OFFICE

ATTN:

ReANN Myers

85004-442700



Thanks a lot
for your help AND
Putting up with 45
old people.

Alan

NOTICE!!

These documents have been scanned!

Do not place un-scanned documents beneath this notice!

Do not remove this notice from this file!

GPO Jacket No. 560-102
Print Order 61540
Rise Business Services, LLC
Job=AZ15 4/30/2019



Box Number= AZ15011



Claim Begin-End: AMC441682-AMC441682

6 Location Notices-Amendments and Supporting Documents



AZ15011-21

AMC450400-AMC453366

MINING CLAIM STATUS REPORT

Data Entered: 02/16/17 am

MTP Checked By: PETZ
GEO Checked By: _____

LEAD SERIAL NUMBER: AMC 441682 thru AMC _____

NUMBER OF CLAIMS & TYPE:

- LODE
- _____ PLACER
- _____ ASSOCIATION PLACER
- _____ MILL SITE
- _____ TUNNEL SITE

CHARGES:

Processing Fee @ \$20 = \$ 20

Location Fee @ \$37 = \$ 37

Maintenance Fee @ \$155 = \$ 155

Add'l Maint Fee for Assoc Placer = \$ _____

SUBTOTAL \$ 212

CUSTOM MAP Other Fees \$ 10

Other Fees \$ _____

TOTAL \$ 222⁰⁰

TOTAL ACREAGE: _____ Per Claim
(Placer Only)

NUMBER OF LOCATORS: 3

DOCUMENTS RECEIVED VIA : Over-the-Counter [] Mail [] **TIMELY FILED:** Yes [] No []

LEGAL DESCRIPTION: T 06 R 06 SEC 33

T _____ R _____ SEC _____

T _____ R _____ SEC _____

T _____ R _____ SEC _____

T _____ R _____ SEC _____

BLM [] FOREST SERVICE [] _____ SUBJ TO PL 359: Yes [] No []
WILDERNESS AREA [] _____

SPLIT ESTATE: N/A [] SX [] PX [] OTHER [] _____
SRHA [] Was proper Notice filed if located on SHRA Land? Yes [] No []

RECONVEYED MINERALS ON BLM LAND REQUIRE OPENING ORDER FROM 1944 TO 1993:
Open to Entry On _____ N/A []

COMMENTS/STATUS: VOID [] PARTIALLY VOID [] PVT MINERALS [] WITHDRAWN LANDS []
OTHER [] _____

[] Claimant acknowledges that portions of the following claim(s) site(s) may be void or voidable.

Printed Name of Claimant _____ Signature of Claimant _____

*****FINAL ADJUDICATION*****

DATE 2/12/2018 INITIALS am

AMC 441682

LOCATION NOTICE FOR LODE MINING CLAIM

Amendment BLM Serial # AMC 441682

NOTICE IS HEREBY GIVEN that the Scorpion Redemption I
_____ lode mining claim has been located

by Stephen Steel, Don Greenwood, whose current mailing
Charles Schermerhorn
address is 428 N. Main
Gladewater, Texas 75847

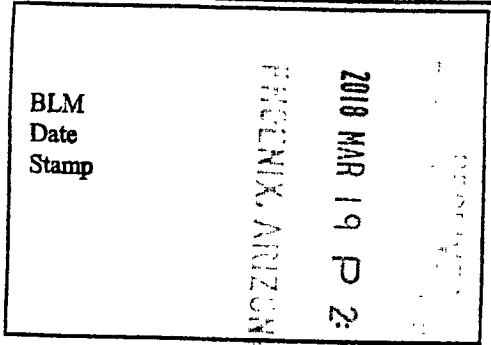

The general course of this claim is North/South ~~600~~ and it is situated in Maricopa
County, Arizona. This claim is 1500 feet in length and 600 feet in width.

20 Total Claim Acreage. This claim runs from the location monument on which this location notice
is posted on the centerline of the claim approximately 1500 feet in a South direction to the South
end line and 300 feet in a S direction to the W end line. This claim is marked by six
monuments, one at each corner and one at the center of each end line of the claim.

The location monument on which this notice is posted is situated within Section 33, Township 6N
_____, Range 6W, Gila Salt River Base and Meridian, Arizona and this claim encompasses portions
of the following quarter section(s), section(s), Township(s) and Range(s) NW Corner of The
SW quarter of Section 33
Gila Salt River Base and Meridian, Arizona.

The locality of this claim with reference to some natural object or permanent monument and additional information
(if any) concerning its locality are as follows: NE Corner is 600ft west of
Center monument of Section 33

_____ The above information is shown on the attached map.

DATED AND POSTED on the ground this 11 day of Feb, 2017.

LOCATOR(s) AGENT

Print Name(s) Don Greenwood Stephen Steel Charles Schermerhorn
Signature(s) [Signature] [Signature] [Signature]

Form MCF100
Revised July 2014

This form is available from the Arizona Geological Survey and may be reproduced.

AMC 441682

MINING CLAIM MAP

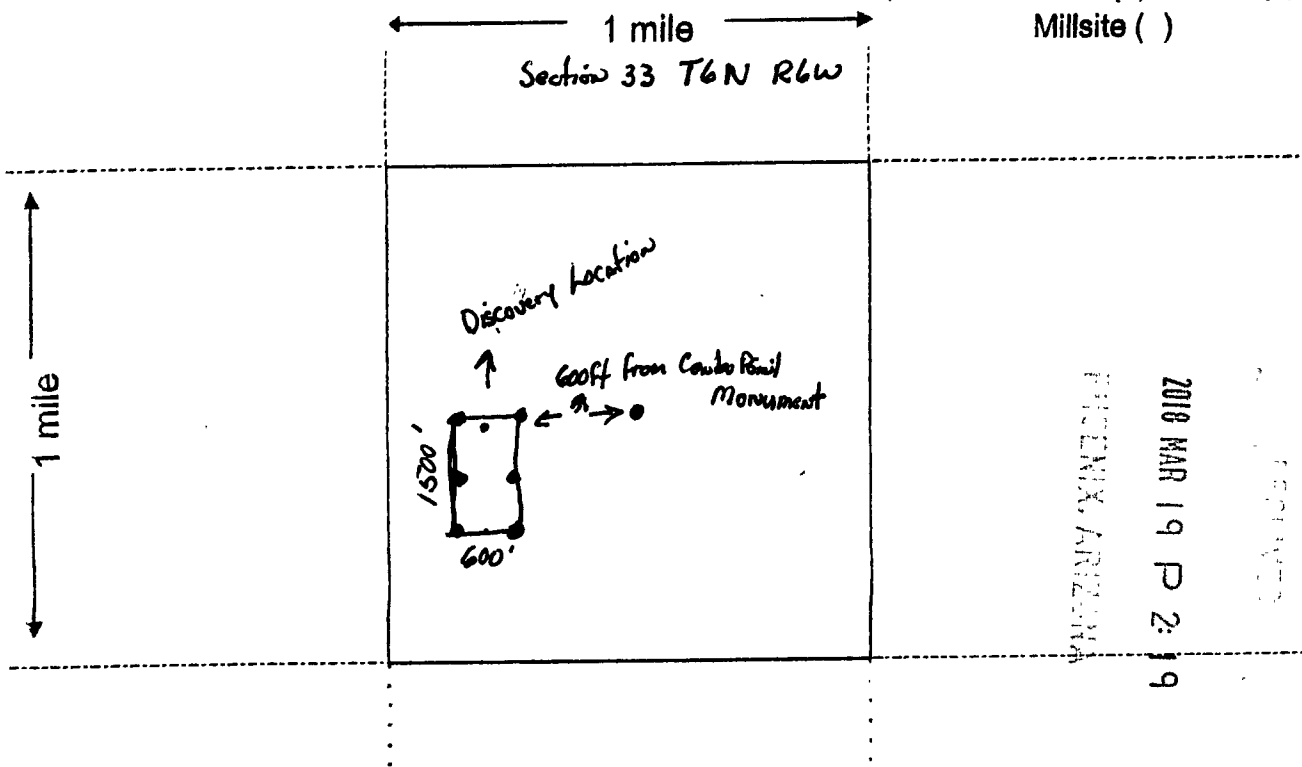

Lode (✓) Placer ()
Millsite ()

Scale: 1" = 2000 feet



1. The above map depicts the Scorpion Redemption mining claim, which is located in Section (s) 33, Township 6 N, Range 6 W, Gila and Salt River Base and Meridian, Maricopa County, Arizona. Total claim acreage is 20
2. The type of corner and location monuments used are as follows: 2" PVC Pipe w cap
in Rock Cairns 5ft Above Ground
3. The bearings and distances in degrees and feet between claim corners and to a public land survey monument are as depicted on the map.
4. If the claim is a placer or millsite claim with exterior limits conforming to legal subdivisions of the public survey, provide a legal description of the claim NW Corner of The SW quarter
of map Sec 33

Form MCF100a
Revised July 2014

This form is available from the Arizona Geology Survey and may be reproduced.

LOCATION NOTICE FOR LODE MINING CLAIM

Amendment BLM Serial # _____

NOTICE IS HEREBY GIVEN that the Scorpio Redemption I
_____ lode mining claim has been located
by Stephen Stale, Charles Schermerhorn, Don Greenwood whose current mailing
address is 428 North Main
Gladewater, TX 75647

RECEIVED
BLM AZ STATE OFFICE
2017 FEB 13 A 11:02
PHOENIX, ARIZONA
BLM
Date
Stamp

The general course of this claim is North/South and it is situated in Maricopa
County, Arizona. This claim is 1500 feet in length and 600 feet in width.

20 Total Claim Acreage. This claim runs from the location monument on which this location notice
is posted on the centerline of the claim approximately 1500 feet in a South direction to the South
end line and 300 feet in a SW direction to the W end line. This claim is marked by six
monuments, one at each corner and one at the center of each end line of the claim.

The location monument on which this notice is posted is situated within Section 33, Township 6N
_____, Range 6 W, Gila Salt River Base and Meridian, Arizona and this claim encompasses portions
of the following quarter section(s), section(s), Township(s) and Range(s) NW corner of the
SW quarter of section 33
Gila Salt River Base and Meridian, Arizona.

AMC441682

The locality of this claim with reference to some natural object or permanent monument and additional information
(if any) concerning its locality are as follows: _____

_____ The above information is shown on the attached map.

DATED AND POSTED on the ground this 11 day of Feb, 20 17.

LOCATOR(s) AGENT

Print Name(s) Stephen Stale Don Greenwood Charles Schermerhorn
Signature(s) Stephen Stale [Signature] Charles Schermerhorn

Form MCF100
Revised July 2014

MINING CLAIM MAP

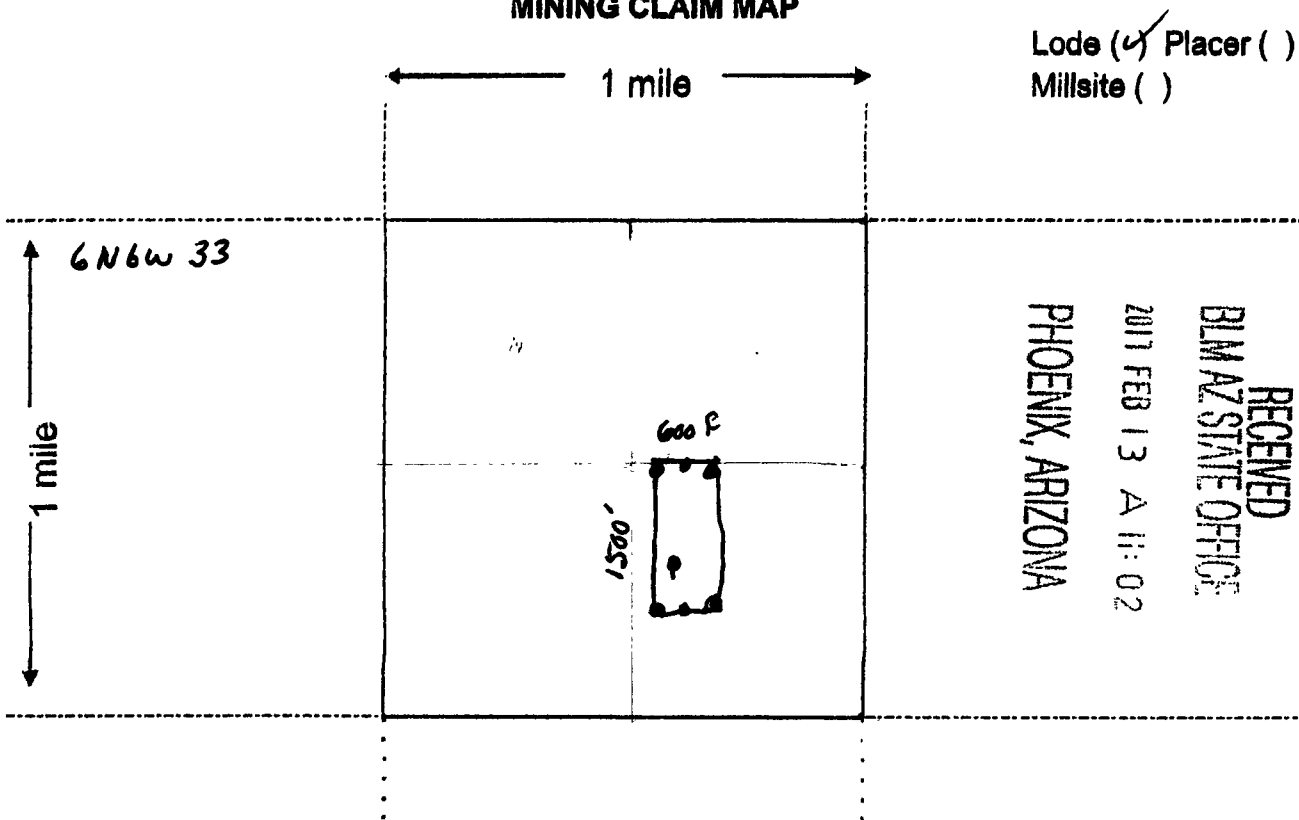

Lode () Placer ()
Millsite ()

RECEIVED
BLM AZ STATE OFFICE
2017 FEB 13 A 11:02
PHOENIX, ARIZONA

AMC441682

Scale: 1" = 2000 feet



1. The above map depicts the Scorpion Redemption 1 mining claim, which is located in Section (s) 33, Township 6 N, Range 6 W, Gila and Salt River Base and Meridian, MARICOPA County, Arizona. Total claim acreage is 20
2. The type of corner and location monuments used are as follows: 2" PVC PINE W CAPS
IN ROCK CORNER 5 FT ABOVE GROUND
3. The bearings and distances in degrees and feet between claim corners and to a public land survey monument are as depicted on the map.
4. If the claim is a placer or millsite claim with exterior limits conforming to legal subdivisions of the public survey, provide a legal description of the claim NW corner of the SW quarter
of map sec 33

Form MCF100a
Revised July 2014

This form is available from the Arizona Geology Survey and may be reproduced.

RUN TIME: 10:51 AM

**DEPARTMENT OF INTERIOR
BUREAU OF LAND MANAGEMENT**

**RUN DATE: 02/13/2017
Page 1 of 1**

Input Parameters for Geographic Report with Land

System Id = CR

Admin State = AZ

Geo State =

Casetype Begins With

Case Disp Txt = AUTHORIZED, CANCELLED, EXPIRED, PENDING, REJECTED, RELINQUISHED, VOID, WITHDRAWN

Mer Twp Rng = 14 0060N 0060W

Section = 033, 999

Mtrs =

Commodity =

Commodity Txt =

Pending Org =

Pend Org Decode =

Total Rows Returned: 4

**NO WARRANTY IS MADE BY BLM FOR USE OF THE DATA
FOR PURPOSES NOT INTENDED BY BLM**

RUN TIME: 10:51 AM

Adm State: AZ

UNITED STATES DEPARTMENT OF INTERIOR
BUREAU OF LAND MANAGEMENT
GEOGRAPHIC REPORT WITH LAND
Sorted by Meridian Township Range

RUN DATE: 02/13/2017
Page 1 of 1

Serial Number: AZA 012037
Total Case Acres: 2,231.010

<u>Casetype</u>	<u>Case Disp</u>			<u>Sect</u>	<u>Sur Typ</u>	<u>Sur Num</u>	<u>Suff</u>	<u>Subdivision</u>	<u>Act Pend</u>
285007	AUTHORIZED	14	0060N	0060W	033	ALIQ		NWNW,S2NW,E2SW,SWSE,	

Serial Number: AZA 031779
Total Case Acres: 1.000

<u>Casetype</u>	<u>Case Disp</u>			<u>Sect</u>	<u>Sur Typ</u>	<u>Sur Num</u>	<u>Suff</u>	<u>Subdivision</u>	<u>Act Pend</u>
293200	EXPIRED	14	0060N	0060W	033	ALIQ		ALL,	

Serial Number: AZA 035150
Total Case Acres: 1.000

<u>Casetype</u>	<u>Case Disp</u>			<u>Sect</u>	<u>Sur Typ</u>	<u>Sur Num</u>	<u>Suff</u>	<u>Subdivision</u>	<u>Act Pend</u>
293200	PENDING	14	0060N	0060W	033	FF		PORTION OF,	

Serial Number: AZAR 0035584
Total Case Acres: 0.100

<u>Casetype</u>	<u>Case Disp</u>			<u>Sect</u>	<u>Sur Typ</u>	<u>Sur Num</u>	<u>Suff</u>	<u>Subdivision</u>	<u>Act Pend</u>
285004	AUTHORIZED	14	0060N	0060W	033	ALIQ		W2NW,SENW,E2SW,SWSE,	

